

**Product and Company Identification**

Product Name: **AB Series**  
 Manufacturer's Name: **Prospec Specialties Inc.**  
 Suite 400, 3601, Highway 7,  
 Markham ON, L3R 0M3, Canada  
 Emergency #: (888) 749-8456  
 Date Prepared: June, 2013

**Table 1: System Details**

Application	Code	JO	SH	SW	± Movement (%)			Load (Ton)
		Millimeter			Horizontal	Vertical	Shear	
Straight ( S )	ABS 01	25	19	25	25	25	Narrow	*
	ABS 02	51	19	48	25	25	Narrow	*
	ABS 03	76	19	73	25	25	Narrow	*
Corner ( C )	ABC 01	25	19	25	25	25	Narrow	*
	ABC 02	51	19	48	25	25	Narrow	*
	ABC 03	76	19	73	25	25	Narrow	*

**JO** = Joint Opening

**SH** = System Height

**SW** = Sight Width

**Key to System Features (Straight Application)**

- 1. Continuous Aluminum  
Recessed frame, grade 6063-T6
- 2. Continuous Silicone Gasket
- 3. Concrete Wall (by others)
- 4. Flat Head Concrete Screw (by others)
- 5. Drywall (by others)

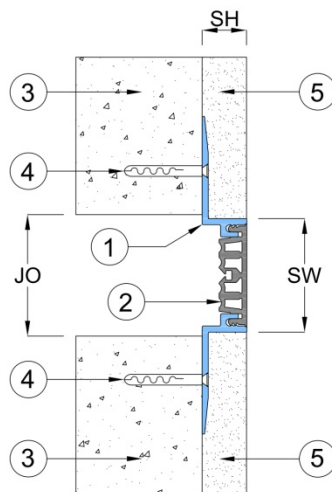

**Key to System Features (Corner Application)**

1. Continuous Aluminum  
Recessed frame, grade 6063-T6
2. Continuous Silicone Gasket
3. Concrete Wall (by others)
4. Flat Head Concrete Screw (by others)
5. Drywall (by others)
6. Continuous Surface mount  
Aluminum frame, grade 6063-T6

