

GH Series

Note: The structural gap and blockout dimensions to be verified before beginning the installation. If the architectural joint system is fire rated, fire barrier has to be installed before the system. For specific system installation, refer to the fire barrier installation instructions.

1. Install the architectural joint system on the finished floor surfaces of the gap opening. The top of finished floor is required to be solid, even, levelled, hard & smooth and free from dust, grit, grime and grease. The expansion gap must be thoroughly cleared and have straight and levelled edges
2. Cut the aluminum system components to the desired length.
3. Apply Concrete epoxy adhesive on both contacting surfaces of gap openings to compression seal surfaces (see figure 1).
4. Position the 1st side of compression seal assembly into the gap opening surface and push to secure in place (see figure 2).
2nd Side, starting at one end of the seal, push inward into the gap opening to seat into place (see figure 2a).
Ensure that seal is in the correct position along the length of the gap opening.

5. Compression seals to be field welded with adhesive.

SEAMS: (see figure 3 & 3a)

A. Verify that the new piece of material is cut to sit well with the end-piece for proper splicing of two sections. Foam seals should be welded and desired length achieved before applying adhesive.

B. In case of mitered corners, **T** and **X** shaped joints should be pre-assembled prior to installation.

Fig.3

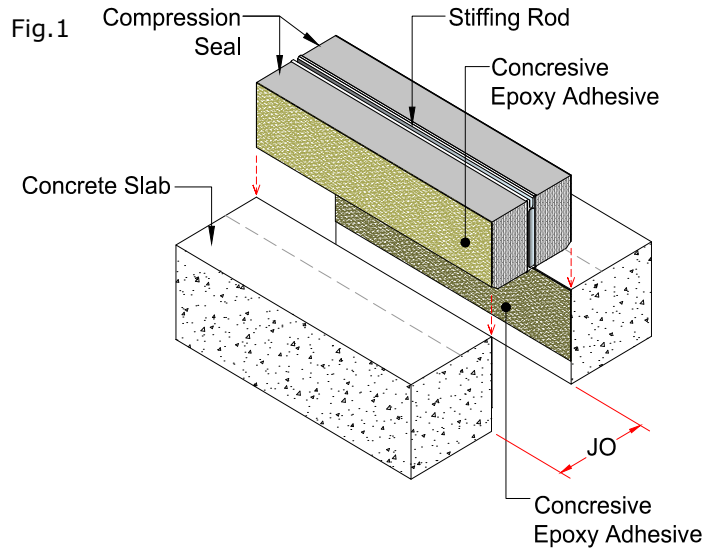
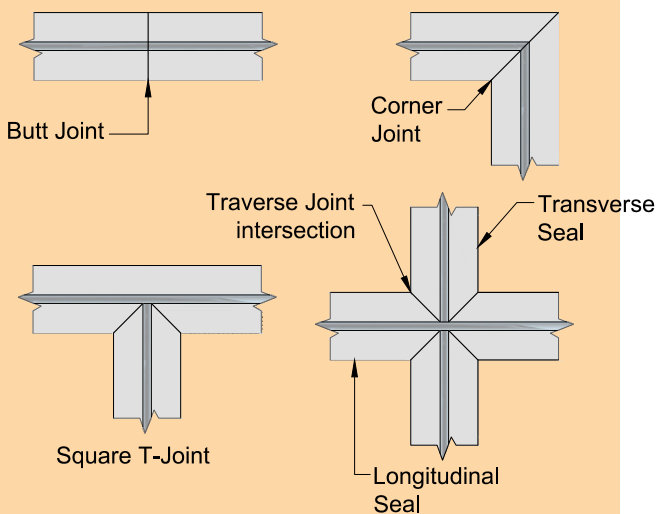

Fig.2

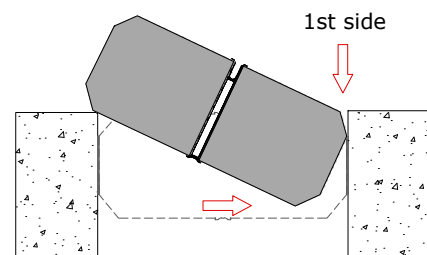

Fig.2a

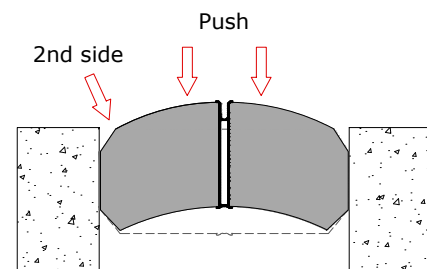
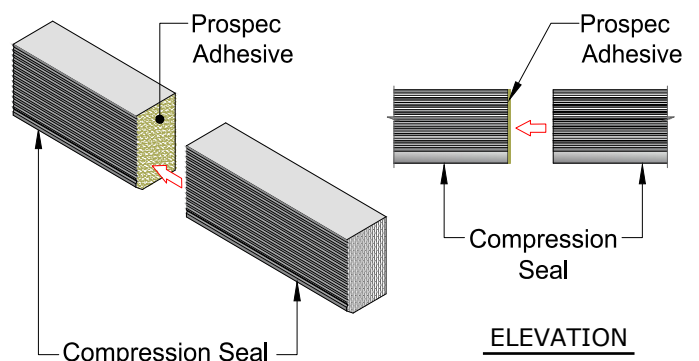

Fig.3a



ISOMETRIC VIEW



GH Series

6. Place the aluminum cover plate on top of compression seal assembly along the gap opening and put some screw drivers as a guide through the holes provided in the center of cover plate. Now align the cover plate on the center of the gap opening using the screw drivers through the holes into the stiffing rod to setup the alignment properly (see figure 4).
7. Draw a line on both edges of finished floor surfaces within the gap opening where the cover plate to be installed as the guide for micro sealant tapes application. Remove the cover plate (see fig.5).
8. Apply micro sealant tape at the reference line on both edges of finished floor surfaces within the gap opening for cover plates installation (see figure 6).
9. Place the aluminum cover plate back on the gap opening and align the pre-drilled holes over the stiffing rod with self-tapping stainless steel screw and tighten to secure in place (see figure 7).
10. After the completion of system installation, clean the exposed surfaces with non-solvent cleaner.

Fig.4

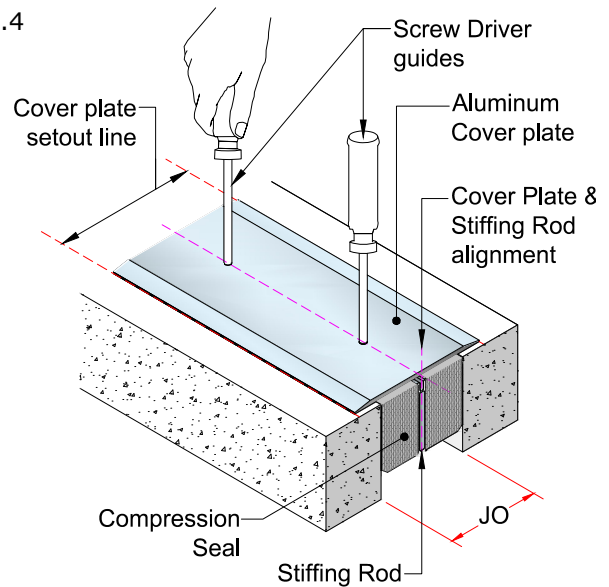

Fig.5

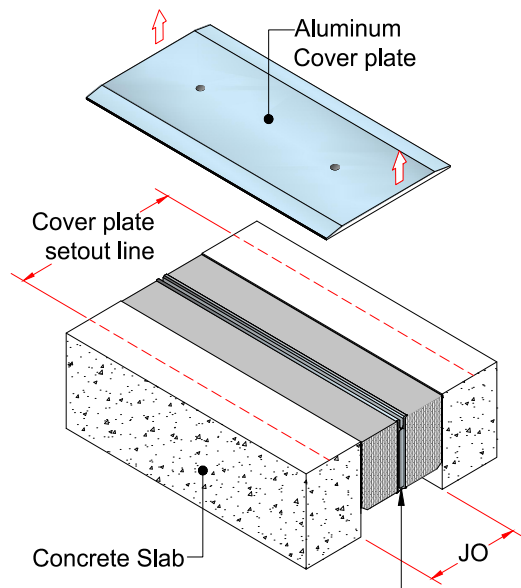

Fig.6

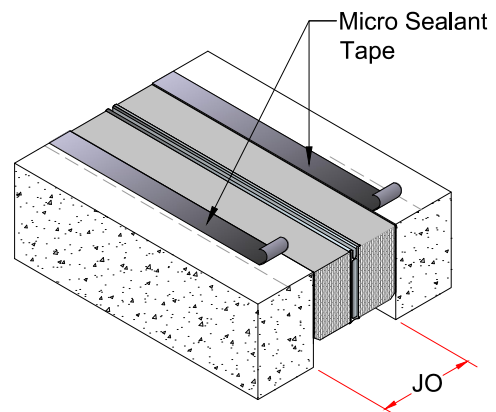

Fig.7

